

Vesta Chair Bolt-Down Assembly Instructions Model Number VA600-XXX / VA610-XXX VA620-XXX / VA630-XXX / VA670-XXX

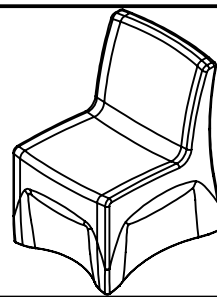

www.norix.com • TEL 800 234-4900

Assembly Notes: Norix is not responsible for any damage due to improper installation. If your shipment does not match the parts list, please contact Norix Customer Service at 800-234-4900.
Norix reserves the right to modify design specifications at any time without an obligation to owners of previously sold products.

ITEM NO.	QTY.	PART NUMBER	DESCRIPTION
8	4	029-075	Forte External Bolt Down Tab
9	4	021-077	Screw, Machine 1/4"-20 X 1", FH, Pin in Torx® T-27, Zinc
10	1	071-001	Pin in Torx Bit, T-27
11	1	VA6XX-XXX	Vesta Chair

STEP 1: Remove mounted glide and pin in torx screw from bottom of chair as shown. Repeat for each corner.

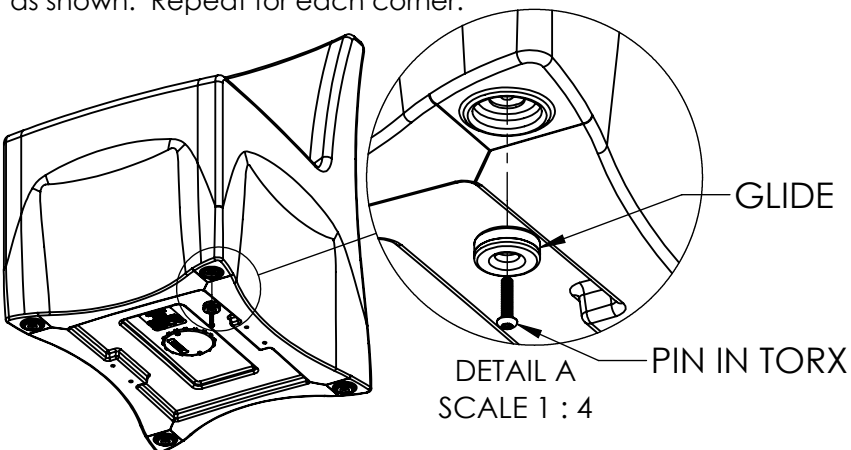

STEP 1: Insert Bolt Down Tab with 1/4"-20 Flat Head screw as shown. Repeat for each corner.

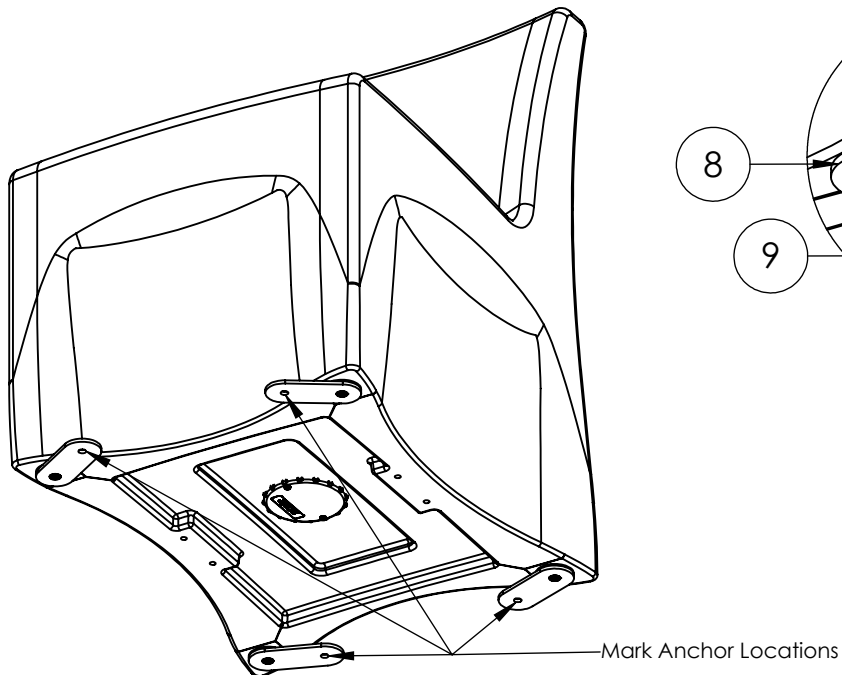
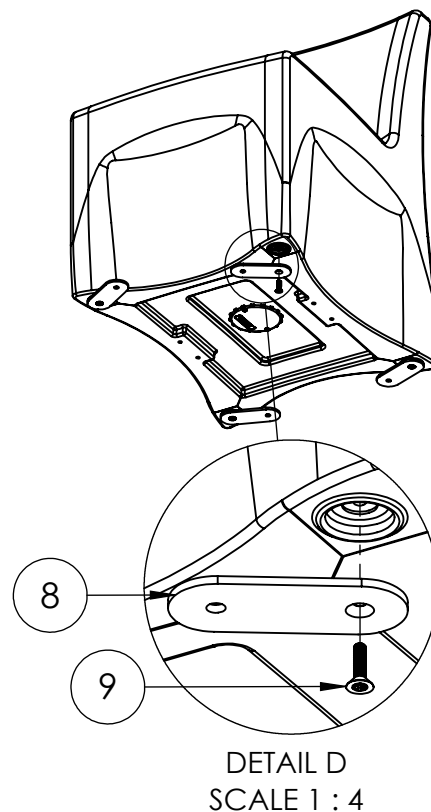

STEP 3: Mark Anchor Locations to the floor and secure the chair to the floor with the bolt down tabs using mounting hardware.